

# EMBOUT "S" : COLLET 3000 PSI

## C4L

coudé à 45°

NORMES : SAE J516-code 61  
SAE J518

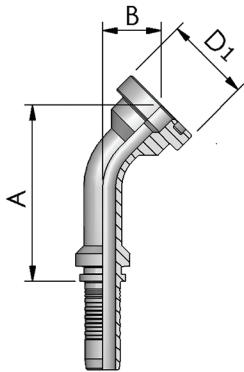

Notes

D.N.		Référence		Dimensions (mm)				
mm	"	Code	Désignation	D1	Ø inter.	L	A	B
10	3/8"	◆	S10 C4L 1/2	30,2	7,0	71,5	41,5	15,0
12	1/2"	1711221	S12 C4L 1/2	30,2	9,5	96,0	64,0	21,0
12	1/2"	◆	S12 C4L 3/4	38,1	9,5	100,0	68,0	25,0
16	5/8"	◆	S16 C4L 1/2	30,2	12,0	89,0	49,0	18,0
16	5/8"	◆	S16 C4L 3/4	38,1	12,0	118,0	78,0	25,0
20	3/4"	1712027	S20 C4L 3/4	38,1	14,5	124,0	80,0	24,0
20	3/4"	1712034	S20 C4L 1"	44,5	14,5	126,0	82,0	27,0
25	1"	1712527	S25 C4L 3/4	38,1	21,0	157,0	103,0	35,0
25	1"	1712534	S25 C4L 1"	44,5	21,0	167,0	113,0	34,0
25	1"	1712542	S25 C4L 1"1/4	50,8	21,0	165,0	111,0	31,0
32	1"1/4	1713234	S32 C4L 1"	44,5	26,5	192,0	134,0	50,5
32	1"1/4	1713242	S32 C4L 1"1/4	50,8	26,5	187,0	129,0	32,0
32	1"1/4	1713249	S32 C4L 1"1/2	60,4	26,5	191,0	133,0	36,0
40	1"1/2	1714049	S40 C4L 1"1/2	60,4	32,0	187,0	123,0	49,0
40	1"1/2	1714060	S40 C4L 2"	71,4	32,0	157,0	93,0	38,0
50	2"	1715060	S50 C4L 2"	71,4	44,0	220,0	148,0	60,0

## C9L

coudé à 90°

NORMES : SAE J516-code 61  
SAE J518

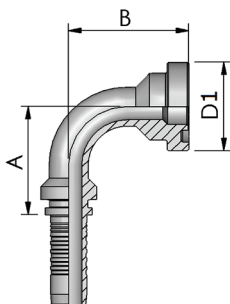

Notes

D.N.		Référence		Dimensions (mm)				
mm	"	Code	Désignation	D1	Ø inter.	L	A	B
10	3/8"	◆	S10 C9L 1/2	30,2	7,0	64	34	37,0
12	1/2"	1721221	S12 C9L 1/2	30,2	9,5	71,0	39,0	42,0
12	1/2"	◆	S12 C9L 3/4	38,1	9,5	71,0	39,0	47,0
16	5/8"	1721621	S16 C9L 1/2	30,2	12,0	89,0	49,0	43,0
16	5/8"	1721627	S16 C9L 3/4	38,1	12,0	88,0	48,0	50,0
20	3/4"	1722027	S20 C9L 3/4	38,1	14,5	94,0	50,0	50,0
20	3/4"	1722034	S20 C9L 1"	44,5	14,5	94,0	50,0	53,0
25	1"	1722527	S25 C9L 3/4	38,1	21,0	128,0	74,0	70,0
25	1"	1722534	S25 C9L 1"	44,5	21,0	126,0	72,0	70,0
25	1"	1722542	S25 C9L 1"1/4	50,8	21,0	126,0	72,0	67,0
32	1"1/4	1723234	S32 C9L 1"	44,5	26,5	150,0	92,0	84,0
32	1"1/4	1723242	S32 C9L 1"1/4	50,8	26,5	146,0	88,0	73,0
32	1"1/4	1723249	S32 C9L 1"1/2	60,4	26,5	146,0	88,0	78,0
40	1"1/2	1724049	S40 C9L 1"1/2	60,4	32,0	172,0	108,0	102,0
40	1"1/2	1724060	S40 C9L 2"	71,5	32,0	155,0	91,0	82,0
50	2"	1725060	S50 C9L 2"	71,5	44,0	198,0	126,0	130,0

